

The information contained in this drawing is the sole property of CWS Coil Winding Specialist. Any reproduction in part or whole without written permission of CWS Coil Winding Specialist is prohibited.

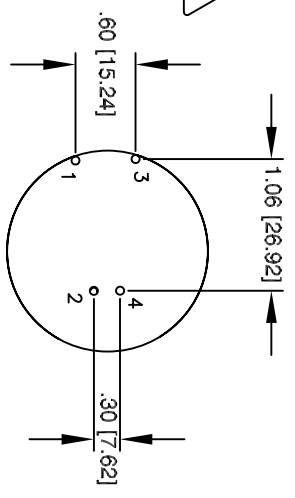
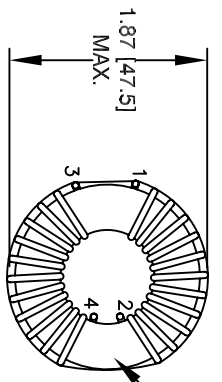
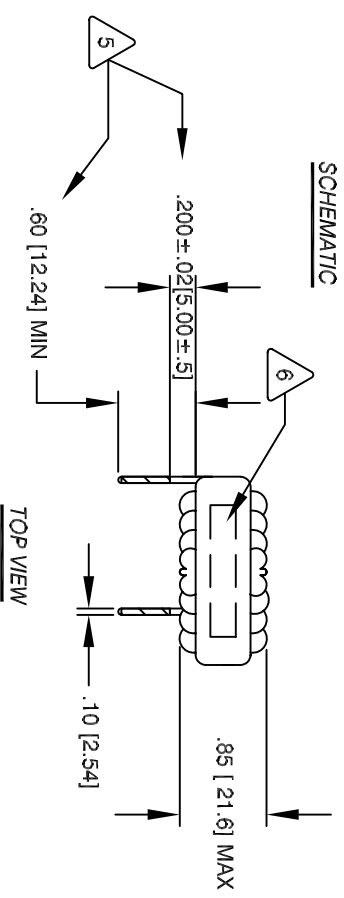
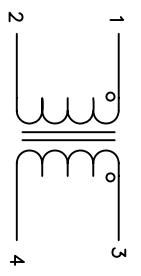

7 BUILT TO ROHS COMPLIANCE AND LEAD FREE

6 USING A PERMANENT MARKING METHOD MARK PART NUMBER AND REVISION NUMBER WHERE SHOWN WRAP INDUCTOR WITH 3M TAPE # 79 OR EQUAL

5 TINNED LEADS MUST BE TANGENT TO CORE STRIP & TIN LEAD UP TO .20 INCH REF FROM BASE OF CORE LEAD LENGTH MUST BE .60 MIN FROM BASE OF CORE

4 CORE EVENLY SPACED, NOTE POLARITY, AWG # 10, SINGLE LAYER ON EACH SIDE TO CONSTRUCTION:

HI-POT TEST FROM WINDING TO CORE: 250 VDC @ 1mA for 1 min
 HI-POT TEST FOR INTERWINDING ISOLATION: 250 VDC @ 1mA for 1 min
 DCR = 3 MILLI-OHMS MAX COMBINED
 DCR (1-2) = 1.9 MILLI-OHMS MAX ; DCR (3-4) = 1.9 MILLI-OHMS MAX
 L = 1.2 mH MIN/COIL, (1 kHz, 1 Vrms)
 3 SPECIFICATIONS @ 25 °C :

2 WIRE: UL RECOGNIZED 200°C RATED MAGNET WIRE CWS BYTEMARK OR OTHER APPROVED PART CORE: COATED FERRITE TOROID, HIGH PERM MNZN

1 MATERIAL: UL RECOGNIZED 94V-0 FOR FLAMMABILITY

NOTES: UNLESS OTHERWISE SPECIFIED, READ FROM BOTTOM UP.

REVISION HISTORY		SIGN & DATE				
REV	ECN	DESCRIPTION	BY	DATE	CHK	DATE
A		PRODUCTION RELEASE	RPR	3/28/05	JLJU	3/28/05
B		UPDATED DIMENSION	KJC	9/19/08	RL	9/19/08

QTY	CODE IDENT	MFG. P/N	DESCRIPTION	ITEM NO.
			PARTS LIST	
	AUTOCAD SOLIDWORKS	X		
	SIGN	DATE		
	DRWN	3/28/05		
	CHKD	3/28/05		
	ENGR	3/28/05		
	APPR	3/28/05		
	SIZE	DWG. NO.	TITLE:	REV
	B	C-36A29-05-LF	Inductor Common Mode	B
	SCALE	1=1		

COLLWS COM, INC
 WWW.COLLWS.COM
 CWS Coil Winding Specialist
 1510 E. Edinger Ave.
 Unit B, Santa Ana, CA, 92705